

Miniature Integral Filter/Regulators

B74



SPECIFICATIONS

Body

- Zinc, black coated

Bonnet

- Glass filled nylon

Polycarbonate Bowl

- Max. pressure 150 psig
- Operating temperature range 40°F to 125°F

Metal Bowl aluminum

- Max. pressure 250 psig
- Operating temperature range 40°F to 175°F

Piston Drain metal

Note: limits bowl temperature and pressure rating

- Max. pressure 150 psig
- Operating temperature range 40°F to 175°F

Body nickel plated zinc

Baffle plastic

Seals Buna N

Elements

- 20 micron sintered bronze
- 5 micron sintered bronze

KITS

Bowl Kits

- Polycarbonate bowl BKF300
- Metal bowl BKF300M

Element Kit

- 20 micron element 2-pack EKF300
- Regulator bonnet repair RB260

Diaphragm Kit

- Relieving diaphragm RK260

Mounting Kits see page 65

- Mounting bracket and ring BR1611
- Mounting bracket ring only PK1611

FEATURES

- Micro seat finish to ensure no reduced pressure creep
- Diaphragm operation
- Relieving style standard
- Three position non-rising adjustment knob; push to lock, pull to adjust, detach to make tamper resistant
- Easily panel mounted
- Tamper-proof cap included
- 20 micron filter

OPTIONS

add suffix to part number in alpha and numeric order

- B** 2-Position Mechanical
Lockout Knob B742B
- G** Gauge (0-160 psi) B742G
- I** Instrument pressure B742I
3 to 20 psi Adjustment
- J** Overnight drain plastic bowl B742J
- K** Overnight drain metal bowl B742K
- L** Low pressure B742L
3 to 60 psi adjustment
- M** Metal bowl B742M
- N** Non-relieving B742N
- P** Panel mount B742P
- Z** Piston drain B742Z
- 5** 5 Micron element B7425

PERFORMANCE CHARACTERISTICS

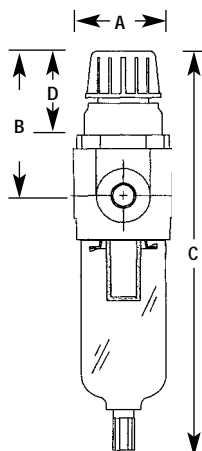
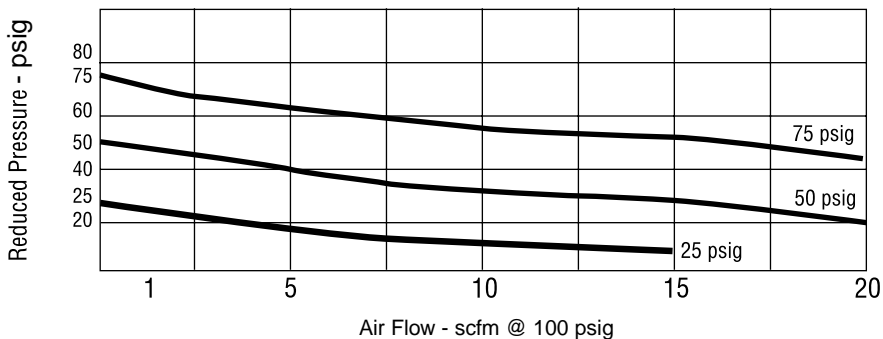

DIMENSIONS

| PIPE SIZE | MODEL NO. | MAX. FLOW SCFM | BOWL CAPACITY | DIMENSIONS (INCHES) | | | | WEIGHT (LBS.) |
|-----------|-----------|----------------|---------------|---------------------|--------|-------|-------|---------------|
| | | | | A | B | C | D | |
| 1/8" | B741 | 20 | 1 oz. | 1 5/8 | 2 3/16 | 6 1/4 | 1 1/4 | .6 |
| 1/4" | B742 | 20 | 1 oz. | 1 5/8 | 2 3/16 | 6 1/4 | 1 1/4 | .6 |