

SPECIFICATION

| TYPE | AJA - 72R | AJA - 72N | AJA - 72P |
|--------------------------|--------------------|--------------------------------------|----------------------------------|
| CHARACTERISTICS | | | |
| SWITCHING LOGIC | SPST Normally Open | Solid State Output, Normally Open | |
| SENSOR TYPE | Reed Switch | NPN Current Sinking | PNP Current Sourcing |
| OPERATING VOLTAGE | 5~240V DC/AC | 5~28V DC | |
| SWITCHING CURRENT | 100 mA max. | 200 mA max. | |
| SWITCHING RATING | 10 W max. | 6 W max. | |
| CURRENT CONSUMPTION | — | 20 mA max. @ 24V (Switch Active) | 19 mA max. @ 24V (Switch Active) |
| VOLTAGE DROP | 2.5 V max. | 0.5 V max. @ 200 mA (Resistive Load) | |
| LEAKAGE CURRENT | — | 0.01 mA max. | |
| INDICATOR | Red LED | Red LED | Green LED |
| CABLE | 3.3φ, 2C, PVC | 3.3φ, 3C, PVC | |
| SENSITIVITY (NOTE 1.) | 40Gauss | | |
| MAX. SWITCHING FREQUENCY | 200 Hz | 1000 Hz | |
| TEMPERATURE RANGE | -10~70 °C | | |
| SHOCK (NOTE 2.) | 30 G | 50 G | |
| VIBRATION (NOTE 3.) | 9 G | | |
| ENCLOSURE CLASSIFICATION | IP 67 (NEMA 6) | | |
| PROTECTION CIRCUIT | None | Reverse Polarity; Surge Suppression | |
| Connect Diagram | | | |

APPLICABLY GROOVE(SMC)

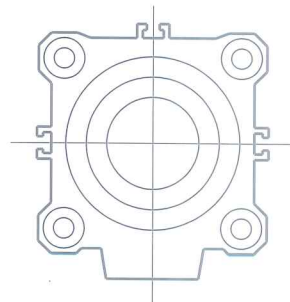
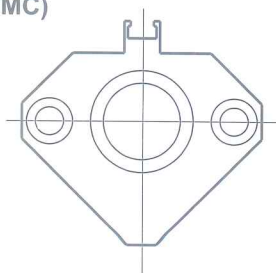

NOTE:

1. Measuring standard target: $\phi 15.5 * \phi 8 * 5t$ (Anisotropic Rubber Magnet).
2. Sin Wave / X、Y、Z 3 Directions / 3 Times Each Direction / 11mS Each Time.
3. Double Amplitude 1.5mm / 10Hz~55Hz~10Hz (Sweep 1min) / X、Y、Z 3 Directions / 1Hour Each Time.