

PAB clamp is designed for mounting AJA-20 & AJA-21 series sensor on 12  $\phi$  ~ 125  $\phi$  round cylinder.

Step 1	Step 2	Step 3	Step 4
Loosen the screw, retaining three or four turns of the screw under the nut.	Place the screw head into the clamp slot of the screw, then assemble the sensor and cylinder with the band wrapping tighten, finally make a mark on the hole which is nearest the pin.	Loosen the band and cut the remnant of the band at the midway of the second hole next the marked hole.	Insert the band which has been cut to the pin, and make the pin hooking the marked hole. Assemble the sensor and cylinder with the band wrapping tighten, and then lock screw to steady the sensor on the cylinder.
<p>Screw Head</p>	<p>Mark Hole</p> <p>Pin</p> <p>Clamp Slot</p>	<p>Mark Hole</p> <p>Cut Line</p>	<p>Do not lock too tighten, or it may damage the switch and/or cylinder.</p>

PBK clamp is designed for mounting AJA-03 & AJA-15 series sensor on round cylinder.

PBK - 01 : For 6 $\phi$ ~ 40 $\phi$ round cylinder to use	Step 1	Step 2	Step 3	Step 4
PBK - 02 : For 6 $\phi$ - 63 $\phi$ Round Cylinder to use	Loosen screw & nut.	Place sensor on the cylinder and wrap them with the band, then hook the nearest hole of the band and make a mark on the hole.	Cut the remnant of the band at the edge of the hole near the marked hole. As follow illustration,	Assemble the sensor and cylinder with the band, then hook the marked hole. Finally, lock the screw to steady the sensor and cylinder.
<p>13.4</p> <p>11.8</p> <p>14.5</p> <p>9</p>		<p>Mark Hole</p>	<p>Cut Line</p> <p>Mark Hole</p>	<p>Do not lock over tighten, or it may damage the sensor and/or cylinder.</p>

**PAC Bracket** Is Designed For Mounting AJA-20 & AJA-21 Series Sensor  
On The Rod-Cylinder.

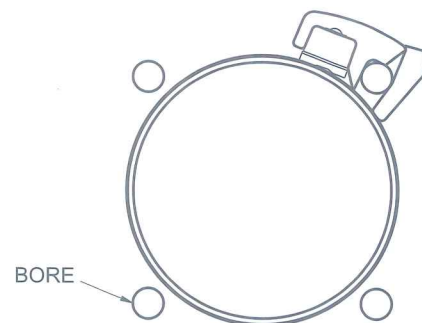
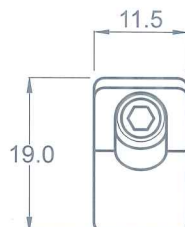
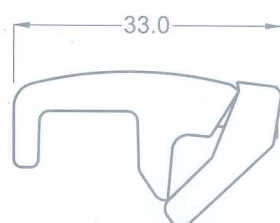

APPLICABLY TO : 32  $\phi$  TO 125  $\phi$  ROD-CYLINDER ( BORE SIZE FROM 5  $\phi$  TO 12  $\phi$  )

**PI Bracket** Is Designed For Mounting AJA-20 & AJA-21 Series Sensor  
On ISO Profile Cylinder.

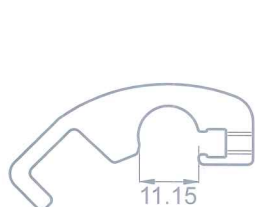

PI-1

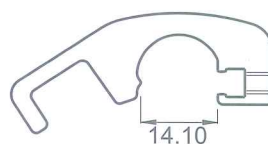
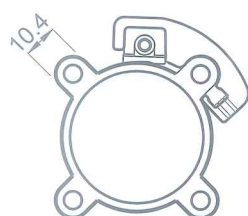

PI-2

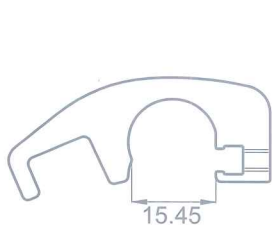
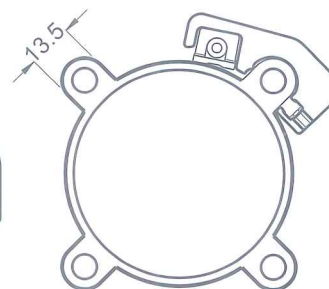

PI-3

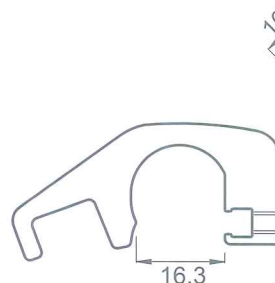
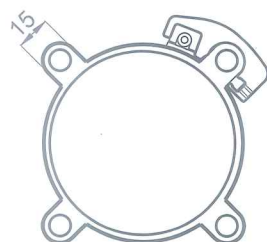

PI-4

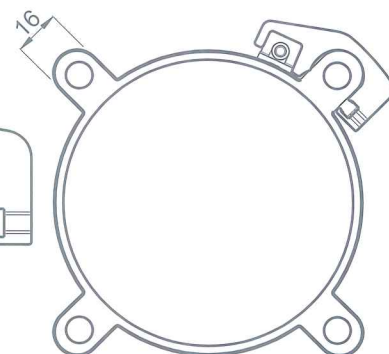

APPLICABLY TO : 32  $\phi$  TO 100  $\phi$  ISO Profile Cylinder